



# INTEGRA

## COACH®

### Odyssey



Serial #: 1JSLECBR2R1EV8051  
 Model: 29V ODYSSEY MHC  
 VIN#: 1FDXE4FNXRDD01757  
 Model Year: 2024 Dealer Name: NATIONAL INDOOR RV CENTERS  
 9515 CONTRACTORS CT  
 MANASSAS, VA 20109  
 USA

### Standard Equipment

THE FOLLOWING ITEMS ARE STANDARD ON THIS MODEL AT NO EXTRA CHARGE

- STANDARD EXTERIOR EQUIPMENT**
- Ford® E-450 chassis
  - GVWR - 14,500 lb.
  - GVHR - 22,000 lb.
  - 3.6L V6 325 HP engine with 450 ft.-lb. torque
  - 6-Speed TorqShift® series transmission with overdrive
  - 2.0L amp alternator
  - CatSrap™ catalytic converter protection
  - E-rated highway tires LT225/75R16
  - Tire pressure monitoring system (TPMS)
  - Power anti-lock brakes with power steering
  - 7,500 lb. hitch with 750 lb. tongue capacity and 4-pin plug
  - Electric power windows
  - 55 gal. fuel tank
  - "TurShell™" vacuum-bond laminated roof, floor and sidewalls
  - Bead/beam insulation (R-24 max roof, R-9 max floor, R-5 max walls)
  - One-piece, seamless, fiberglass roof
  - Aluminum running boards
  - Fiberglass exterior walls with vinyl graphics
  - Entering deck with industry's largest level-view window
  - Electric-powered entrance step with integrated house battery compartment
  - Slide-out cover awnings
  - Pass-through storage compartment with light (select models)
  - Exterior LED HD Smart TV with (2) high-output, marine-grade exterior speakers
  - Front loader (248, 25R, 25M, 27U, 29V, 31F)
  - 4-in. bumper tube sewer hose storage
  - Prep for satellite dish
  - Cable TV hookup with RG-6 coax
  - Wi-Fi/2.0 Wi-Fi/4G antenna
  - 4,000W generator
  - Solar prep
  - 1,000W inverter
  - 12V house battery
  - 3-amp electrical service
  - 12.2 gal. propane tank (41 lb.)
  - LP quick-connect hookup
  - Exterior utility center
  - Ventilation drain system
  - Outside shower
  - 12V demand water pump
  - Water filtration system

- CUSTOMER VALUE PACKAGE**
- 12V front and rear stainless driveshaft, standard dog and chain
  - 12V front and rear stainless helper springs, under isolation body mounts
  - One-piece, seamless fiberglass front cap
  - Automotive-bonded panoramic window in front cap with power shade
  - Frameless windows
  - Heated holding tanks (12V pads)
  - Electric patio awning with LED lights
  - Black tank flush
  - Sony® microphone center with Apple CarPlay® and Android Auto™
  - Backup and side-view cameras
  - LED HD Smart TV in living area

### Optional Equipment

OPTIONAL EQUIPMENT INSTALLED ON THIS VEHICLE BY MANUFACTURER

- STANDARD INTERIOR EQUIPMENT**
- Swivel driver and passenger seats
  - Remote-controlled, side-view mirrors
  - Tilt steering wheel
  - Hill descent control
  - Cruise control
  - Electronic stability control
  - Traction control
  - Auxiliary start switch
  - Power windows and door locks
  - Driver and passenger airbags
  - Privacy curtain for cab area
  - Remote keyless cab entry
  - Custom molded ABS surround in cab-over-area
  - Overhead storage (750 lb. capacity and safety rail)
  - 84-in. ceiling height
  - High-intensity recessed LED lights
  - LED-ill. slideout fascia
  - Hand-hold cabinet doors and drawer fronts
  - Ball-bearing drawer guides
  - Interior entrance door grab handle
  - Interior command center
  - Fiberglass cabinet staves
  - 30,000 BTU auto-ignition furnace
  - Electric fireplace (25M, 30Z)
  - 6 gal. gas/electric DSI auto-ignition water heater
  - Entegra-exclusive, easy-operation legless dinette table
  - 2-point lap safety belts in all designated seating locations
  - Car seat leathers (select floorplans)
  - Smoke alarm
  - Carbon monoxide detector
  - The extra quarter
  - 12V DC refrigerator
  - Furnace all-in-one cooktop and oven
  - Residential-size microwave
  - LED-ill. kitchen countertops
  - Recessed stainless steel kitchen sink with cutting board sink cover
  - Decorative kitchen backsplash
  - Pop-up charging station with 120V outlet and USB plugs
  - Queen-size bed with bedspread (24B, 25R, 25V, 30Z, 31F)
  - King-size bed with bedspread (2ZU)
  - King-size power Murphy bed (25M)
  - USB port and wireless charging in highstands (27U, 29V, 30Z, 31F)
  - USB port in cabinet over bed (24B, 25R, 25M)
  - Under-bed storage (select models)
  - Bedroom TV prep
  - Large wardrobes
  - Bunks with industry-exclusive, 300 lb. capacity each (31F)
  - Wall-mounted tablet holder in each bunk (31F)
  - Shower with decorative surround, glass door, skylight and light
  - Recessed stainless steel bathroom sink
  - Porcelain toilet with foot flush
  - Powered foot vent in bathroom with wall switch

- OPTIONAL EQUIPMENT INSTALLED ON THIS VEHICLE**
- Base price 157,793.00
  - ASHVILLE n/c
  - DIAMOND ICE GRAPHICS n/c
  - PACKAGE n/c
  - USA STANDARDS n/c
  - 24 FD E45 14500 158\* 6,000.00
  - 7.3L WHITE RC10 1,193.00
  - CUSTOMER VALUE PACKAGE 383.00
  - DUAL ACS BEDROOM TV 3,893.00
  - HYDRAULIC AUTO LEVELING JACKS 893.00
  - 200W ROOF MOUNTED SOLAR PANEL W/2ND HOUSE BATTERY STANDARD HOUSE BATTERY n/c
  - SUN FOLDING WINDSHIELD SHADE 488.00
  - THEATER SEATING SOFA 743.00

UNIT TOTAL

171,386.00

DEALER INSTALLED OPTIONS

## Manufacturer's Suggested Retail Price \$171,386.00

TOTAL AMOUNT DOES NOT INCLUDE STATE AND LOCAL TAXES OR LICENSE FEES. THE PRICE SHOWN ABOVE MAY OR MAY NOT BE REPRESENTATIVE OF THE ACTUAL SELLING PRICE OF SIMILAR RECREATIONAL VEHICLES IN YOUR AREA.

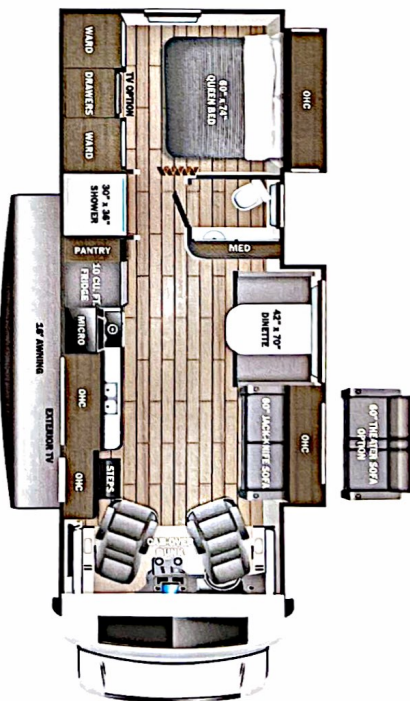

- DIMENSIONS**
- Exterior height: 140.00\*
  - Exterior width: 100.00\*
- CAPACITIES**
- Fresh water tank (gals.): 47.00
  - Gray water tank (gals.): 41.00
  - Black water/coilet tank (gals.): 32.00
  - Propane (lbs.): 41
  - Propane (gals.): 9
  - Water heater (gals.): 6.00

- TIRES**
- Tire size (front): LT225/75R16E
  - Tire size (mid): LT225/75R16E
  - Tire size (rear): LT225/75R16E

\*\*\*Some dimensions may be rounded and may vary from the actual dimensions\*\*\*  
 \*\*\*Weights may be estimated calculations and may vary from the actual weight\*\*\*  
 - refer to the vehicle weight labels for actual weights\*\*\*  
 Floorplans, features and specifications are subject to change without notice.