



ENTEGRA COACH®

Accolade XL



Serial #: 1J5NCEB2S1LM8116
 Model: 37M ACCOLADE XL MHC
 VIN#: 4U2ADVF5C5CWH0465
 Model Year: 2025 Dealer Name: NATIONAL INDOOR RV CENTERS

4640 NEXUS WAY
 NORTH LAS VEGAS, NV 89115
 USA

Standard Equipment

- STANDARD EXTERIOR EQUIPMENT**
- Flagpole w/ 52RV front engine diesel Super-C cab chassis
 - Cummins® ISB 6.7L 360 HP diesel engine with 800 lb. torque
 - Allison 3000 MH automatic transmission
 - Variable geometry engine exhaust brake
 - 185 amp alternator
 - 12,000 lb. rear hitch receiver
 - 7-pin plug
 - Dual 12V chassis batteries - 1900 CCA
 - 10 gal. DEF tank
 - 10 gal. DEF tank
 - (4) 6V AGM (220Ah) house batteries on sidestair
 - Power solar panel with dual controller
 - Dual 15,000 BTU A/C unit with heat pump on main A/C
 - 5,000 BTU thermostat-controlled electric fireplace
 - Exterior utility center
 - Winterization drain system
 - Black tank flush
 - 12V demand water pump
 - Water filtration system
 - Power windows and door locks
 - Full-body occupant heating/heated steering wheel
 - Tilt-Slide™ with laminated roof, floor and sidewalls for superior insulation and sound absorption
 - One-piece, seamless, covered fiberglass roof
 - Bed-in foam insulation (R-24 max roof, R-9 max floor)
 - One-piece, seamless, fiberglass front and rear caps
 - Automotive-bonded panoramic window in front cap with power shade
 - Automatic hydraulic leveling jacks
 - Exterior entertainment center with outside speakers, Minigrip® aluminum handrails and A/R/FM radio
 - Deluxe heated, remote-controlled, side-view mirrors
 - Entrance door with industry's largest travel-view window
 - Electric-powered entrance step
 - Slide-out cover awnings
 - Chrome exterior baggage door handles and locks
 - Full-body occupant heating/heated steering wheel
 - Electric power windows
 - With lockable slam latch doors

Optional Equipment

- STANDARD INTERIOR EQUIPMENT**
- 6-way power driver and passenger seats
 - Auxiliary start switch
 - Privacy curtains for cab area
 - Custom-molded ABS surround in cab-over area
 - Overhead bunk with 750 lb. capacity and safety net with 300 lb. capacity
 - Freely-Multiplex system offers control of important coach features via LED touchscreens or mobile app
 - High-intensity recessed LED ceiling lights
 - Plush, heated captain's chairs
 - Plush heated captain's chairs
 - Matte-finish wood-grain porcelain floor tile with heated floor mat
 - Paylight roller shades in living area
 - Car seat belt on forward-facing dinette table
 - 2-point lap safety belts in all designated seating locations
 - 80 in. LED TV in living area (40 in. on 37K)
 - Cable TV hookup with RG-5 coax and video selector switch
 - Wood-trimmed kitchen window with spice cabinets
 - 8-burner induction cooktop with LED display
 - Stainless steel sink with large integrated
 - Walk-around, king-sized bed with bedspread and nightstands
 - 42 in. smart LED TV in bedroom
 - In-cab watercloset
 - Bunks with industry-exclusive 300 lb. capacity each (37L)
 - One-piece, fiberglass shower with glass door, skylight and light
 - Porcelain toilet with foot flush
 - Solid-surface bathroom sink
 - Powered roof vent in bathroom with well switch
 - Smoke alarm
 - Carbon monoxide detector
- OPTIONAL EQUIPMENT INSTALLED ON THIS VEHICLE BY MANUFACTURER**
- | | |
|---|------------|
| Base price | 395,100.00 |
| SUNLIT DEOR | N/C |
| DOVE WHITE CABINETRY | 30.00 |
| DOVE WHITE FRONT OVERHEAD ACCENT WOOD | N/C |
| TACOMA SHADOW TILE BRUN BLUE PAINT | 30.00 |
| USA STANDARDS | N/C |
| 25 FR SPRV 31000 279* | N/C |
| 360 SA15 | 11,250.00 |
| CUSTOMER VALUE PACKAGE WASHER/DRYER STACKABLE IN MOTION DISH SATELLITE SYSTEM | 2,393.00 |
| BOOTH DINETTE | N/C |
| POWER THEATER SEATING | N/C |
| SOFA | N/C |

- CUSTOMER VALUE PACKAGE**
- EZ Drive™ Premier, Computer-balanced drivetrain, rear air
 - SACHS shocks
 - Dual-pane, tinted, safety-glass windows
 - Flood-mounted Girards patio awning with LED lights
 - 2,000V pure sine wave inverter
 - Aqua-Hot® 250D hydronic water and heating system with 5 in. LED screen
 - 9 in. Sport® stabilament center with Apple CarPlay® and Backup and side-view cameras
 - Stainless steel residential refrigerator
 - Flush-mounted convection microwave

UNIT TOTAL
408,833.00

DEALER INSTALLED OPTIONS

Manufacturer's Suggested Retail Price

\$408,833.00

TOTAL AMOUNT DOES NOT INCLUDE STATE AND LOCAL TAXES OR LICENSE FEES. THE PRICE SHOWN ABOVE MAY OR MAY NOT BE REPRESENTATIVE OF THE ACTUAL SELLING PRICE OF SIMILAR RECREATIONAL VEHICLES IN YOUR AREA.

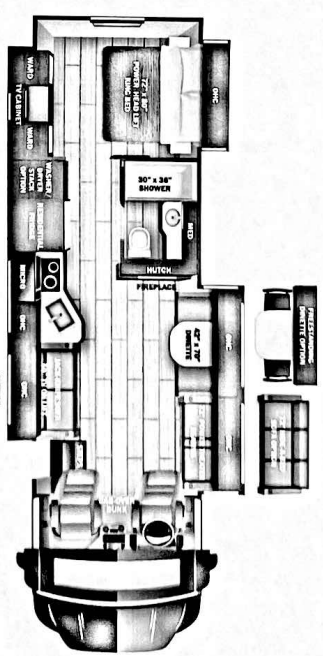

- DIMENSIONS**
- Exterior height: 160.00*
 - Exterior width: 101.00*
- CAPACITIES**
- Fresh water tank (gals.): 72.00
 - Gray water tank (gals.): 80.00
 - Black water/collet tank (gals.): 55.00
 - Propane (lbs.): 0
 - Propane (gals.): 0
 - Water heater (gals.): 0.00

- TIRES**
- Tire size (front): 275/80R22.5G
 - Tire size (mid): 275/80R22.5G
 - Tire size (rear): 275/80R22.5G

Some dimensions may be rounded and may vary from the actual dimensions
 Weights may be estimated calculations and may vary from the actual weight
 *refer to the vehicle weight labels for actual weights***
 Floorplans, features and specifications are subject to change without notice.