



ENTEGRA

COACH®

Accolade

Serial #: 1J5NECBUXR1HL8071
 Model: 37L ACCOLADE MHC
 VIN#: 4UZADVFC6RCVH4256
 Model Year: 2024 Dealer Name: NATIONAL INDOOR RV CENTERS

4640 NEXUS WAY
 NORTH LAS VEGAS, NV 89115
 USA



Standard Equipment

THE FOLLOWING ITEMS ARE STANDARD ON THIS MODEL AT NO EXTRA CHARGE

- STANDARD EXTERIOR EQUIPMENT**
- Freshpliner® SZRV chassis
 - GVWR - 31,000 lb
 - GVWR - 43,000 lb
 - Cummins® ISB 6.7L 360 HP diesel engine with 800 ft-lb torque
 - Allison® 3000 MH automatic transmission
 - 185-amp alternator
 - Gr-rated highway tires - 275/80R22.5
 - Graded aluminum rims
 - Graded exhaust brake
 - 12,300 lb crush with 1,200 lb tongue capacity
 - 7-pin plug
 - Dual 12V chassis batteries
 - 100 gal DEF tank
 - 10 gal DEF tank
 - TuffShell™ vacuum bond laminated roof, floor and sidewalls
 - Bead/foam insulation (R-24 max roof, R-9 max floor, R-8 max walls)
 - One-piece seamless, crowned fiberglass roof
 - Airmium Skivert® full-body panel
 - Airmium hydraulic leveling jacks
 - Entrance door with industry 5 digit/exit travel-view window
 - Electric-powered entrance steps
 - Slideout cover awnings
 - Exterior entertainment center with outside speakers and LED HD Smart TV mounted on swivel bracket
 - Winegard® In-motion satellite dish
 - Carpeted, full-pass-through storage compartments with lockable slam latch doors
 - The(only) Star-Con Turbo macerator system
 - Flood brake light
 - Cable TV hookup with RG-6 coax and video selector switch
 - Winegard 2.0 W-FI/4G antenna
 - Onan® 8,000W Quiet Diesel generator and auto-gen start
 - 200W solar panel with dual controller
 - (4) 6V AGM (220Ah) house batteries on slideout tray
 - Transfer switch with reverse polarity protection
 - 25 gal propane tank (83 lb)
 - LP gas hookup
 - Exterior utility center
 - Winenzation drain system
 - Back tank flush
 - Outside shower
 - 12V demand water pump
 - Water filtration system

OPTIONAL EQUIPMENT INSTALLED ON THIS VEHICLE BY MANUFACTURER

Optional Equipment

- STANDARD INTERIOR EQUIPMENT**
- 6-way power driver and passenger seats
 - Deluxe heated, remote-controlled, side-view mirrors
 - Tilt steering wheel
 - Cruise control
 - Detroit automatic wipers/headlights
 - Power windows and door locks
 - Auxiliary start switch
 - Custom-molded ABS surround in cab-over area
 - Overhead bunk with 750 lb capacity
 - Privacy curtains for cab area
 - Privacy curtains for kitchen, wall-mounted touchscreen and mobile app for tea station, wall-mounted
 - 84 in. interior ceiling height with padded vinyl ceiling
 - High-intensity recessed LED ceiling lights
 - Vinyl plank flooring
 - Hardwood cabinet doors and drawer fronts
 - Deluxe hidden cabinet hinges
 - Ball-bearing drawer guides
 - 30,000 BTU auto-ignition furnace
 - 10 gal gas/electric water heater
 - Electric fireplace
 - Energy-efficient, easy-operation legless dinette table
 - Full-size refrigerator (all sizes)
 - Cow seatbelts (seated locations)
 - LED HD Smart TV in living area
 - Smoke alarm
 - Carbon monoxide detector
 - Fire extinguisher
 - Wood-framed kitchen window with spice cabinets
 - 2-burner induction cooktop
 - LED-ill, solid-surface kitchen countertops with recessed stainless steel sink and sink covers
 - Walk-around, king-size bed with power head lift, bedspread and nightstands
 - Under-bed storage (selected models)
 - LED HD Smart TV in bedroom
 - Large wardrobes
 - Bunks with industry-exclusive 300 lb capacity each (37L)
 - Wall-mounted tablet holder in each bunk (37L)
 - Shower with decorative surround, glass door, skylight and light
 - Porcelain toilet with foot flush
 - Recessed stainless-steel bathroom sink
 - Powered roof vent in bathroom with wall switch

Base price	345,000.00
FOSSIL	n/c
SUNDAIL FULL PAINT	30.00
USA STANDARDS	n/c
24 FR SZRV 31000 279*	
560 RATS	n/c
CUSTOMER VALUE PACKAGE	6,750.00
RESIDENTIAL REFRIGERATOR	n/c
WASHER/DRYER COMBO	1,943.00
IN MOTION DISH SATELLITE SYSTEM	n/c
SLIDEOUT TRAY W/ELECTRIC COOLER IN BASEMENT	1,193.00
HAB SOFA	n/c

UNIT TOTAL **354,916.00**

DEALER INSTALLED OPTIONS

Manufacturer's Suggested Retail Price \$354,916.00

TOTAL AMOUNT DOES NOT INCLUDE STATE AND LOCAL TAXES OR LICENSE FEES. THE PRICE SHOWN ABOVE MAY OR MAY NOT BE REPRESENTATIVE OF THE ACTUAL SELLING PRICE OF SIMILAR RECREATIONAL VEHICLES IN YOUR AREA.

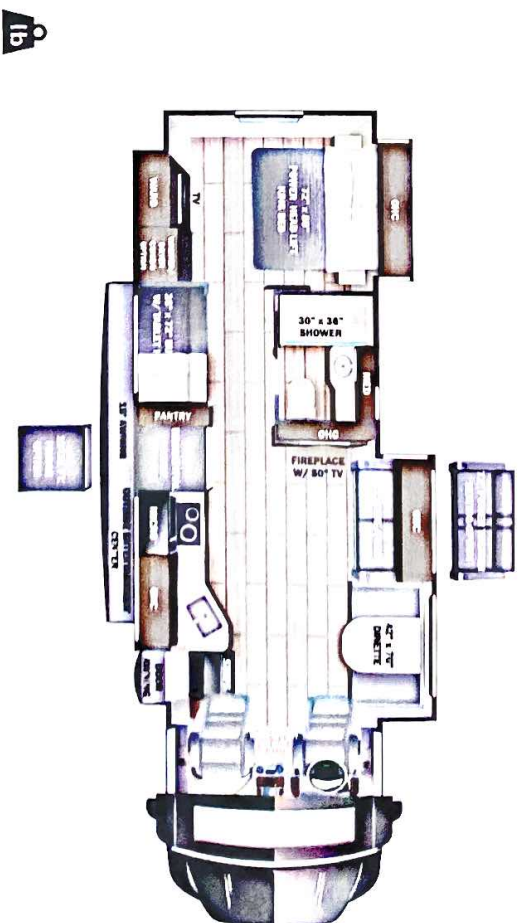

DIMENSIONS

Exterior height: 160.00"
 Exterior width: 101.00"

CAPACITIES

Fresh water tank (gals.): 72.00
 Gray water tank (gals.): 11.00
 Black water toilet tank (gals.): 50.00
 Propane (lbs.): 83
 Propane (gals.): 19
 Water heater (gals.): 0.00

TIRES

Tire size (front): 275 80R22.5G
 Tire size (mid): 275 80R22.5G
 Tire size (rear): 275 80R22.5G

Some dimensions may be rounded and may vary from the actual dimensions
 Weights may be estimated calculations and may vary from the actual weight
 - refer to the vehicle weight labels for actual weights***
 Floorplans, features and specifications are subject to change without notice.