



ENTEGRA

COACH®

SN 10477

Accolade XT

Serial #: 1JUSNECBR0R1JU8051
 Model: 32U ACCOLADE XT MHC
 VIN#: 1FDFE6LTXPDA02130
 Model Year: 2024 Dealer Name: NATIONAL INDOOR RV CENTERS
 4640 NEXUS WAY
 NORTH LAS VEGAS, NV 89115



Standard Equipment

THE FOLLOWING ITEMS ARE STANDARD ON THIS MODEL AT NO EXTRA CHARGE

- STANDARD EXTERIOR EQUIPMENT**
- Ford® F600 4x4 chassis
 - GVWR - 22,000 lb.
 - GVWR - 34,000 lb. w/ Turbo diesel engine with block heater - 330 HP at 2,400 RPM and 825 ft. lb. torque at 2,000 RPM
 - 10-speed automatic transmission
 - Alternator ties - 25/5/20/19.5
 - HiSpec matte black aluminum rims
 - 2 in. BDS radius arm suspension lift
 - 7.500 duty rear hitch receiver
 - Ford® AdvanceTrac® with RSC® (roll stability control) and trailer sway control
 - Pro Performance Trailer Brake System (PPTBS)
 - Single axle trailer (50 CCA 78 AH)
 - Dual fuel tanks (2x 5 gal. and 40 gal.)
 - TuffShell™ vacuum-bond laminated roof, floor and sidewalls
 - One-piece, seamless, crowned fiberglass roof
 - Premium Steaks® full-body paint
 - Electric power windows
 - Electric powered entrance steps
 - Electric cover awnings
 - Exterior entertainment center with outside speakers, LED lighting and 12V power outlet
 - Winged® In-motion satellite dish
 - Full pass-through storage compartments with lockable stem lock doors
 - Third brake light
 - Roof ladder
 - Case TV hookup with RG-6 coax
 - 12V power outlet (12V Quiet Diesel) generator and auto-pen start
 - (2) 8V AGM house batteries
 - Transfer switch with reverse polarity protection
 - 24.5 gal. propane tank (83 lb.)
 - LP quick-connect hookup
 - Exterior utility center
 - LP quick-connect system
 - Black tank flush
 - Outside shower
 - 12V demand water pump
 - Water filtration system

Optional Equipment

OPTIONAL EQUIPMENT INSTALLED ON THIS VEHICLE BY MANUFACTURER

- STANDARD INTERIOR EQUIPMENT**
- Ford® SYNC3 infotainment center with navigation
 - Audible lane departure warning
 - Pre-Collision Assist™ with automatic emergency braking
 - SOS Post-Crash Alert System™
 - Driver and passenger airbags
 - Safety Category® system with roll-over side-curtain airbags
 - Smart keyless entry and perimeter anti-theft alarm
 - Smart keyless start
 - Quad dual-beam halogen headlights
 - Rainlamp wiper activated headlights
 - Automatic start
 - Automatic climate control
 - Individual tire pressure monitoring system (TPMS)
 - Cruise control
 - Power windows and door locks
 - 8-way power driver seat
 - Tilt steering wheel
 - Custom-molded ABS surround in cab-over-area
 - 12V power outlet with 5A fuse
 - Firefly Multiplex system - wall-mounted touchscreen and mobile app for total coach control
 - 8 ft. interior ceiling height with padded vinyl ceiling
 - Recessed LED lighting
 - Raised-panel hardwood cabinet doors and drawer fronts
 - Beige interior cabinet hinges
 - Beige interior cabinet hardware
 - 10 gal. gas/electric water heater
 - 2-point lap safety belts in all designated seating locations (including the driver's seat)
 - LED HD Smart TV in living area
 - Smoke alarm
 - Carbon monoxide detector
 - LED light
 - LED sill, solid-surface kitchen countertops with recessed stainless steel sink and sink covers
 - Pull-out countertop extension (select models)
 - 12V power outlet, king-size bed with bedspread and nightstands
 - LED HD Smart TV in bedroom
 - Furroro® electric fireplace in bedroom (36L)
 - Furroro® electric fireplace (select models)
 - Large wardrobe
 - Decorative shower surround with glass door, skylight and light separating porcelain tub
 - Powered roof vent in bathroom with wall switch

- CUSTOMER VALUE PACKAGE**
- E-Z Drive™ Premier™ Computer-balanced drivetrain, heavy-duty front and rear suspension bars, heavy-duty torsion bars, King® shocks
 - One-piece, seamless, fiberglass front cap with auxiliary flood lights
 - One-piece, seamless, fiberglass rear cap with auxiliary flood lights
 - Automatic bonded, panoramic window in front cap with power shade
 - 3.500 BTU/Cool
 - 13.500 BTU/Cool
 - Electric, wind-sensing, legless patio awning with LED lights
 - 2,000W pure sine wave inverter
 - 2,000W pure sine wave inverter controller
 - Stainless satellite internet system
 - Backup and side-view cameras
 - Two burner induction cooktop
 - Connection inductors oven

UNIT TOTAL **355,553.00**

DEALER INSTALLED OPTIONS

Manufacturer's Suggested Retail Price \$355,553.00

TOTAL AMOUNT DOES NOT INCLUDE STATE AND LOCAL TAXES OR LICENSE FEES. THE PRICE SHOWN ABOVE MAY OR MAY NOT BE REPRESENTATIVE OF THE ACTUAL SELLING PRICE OF SIMILAR RECREATIONAL VEHICLES IN YOUR AREA.

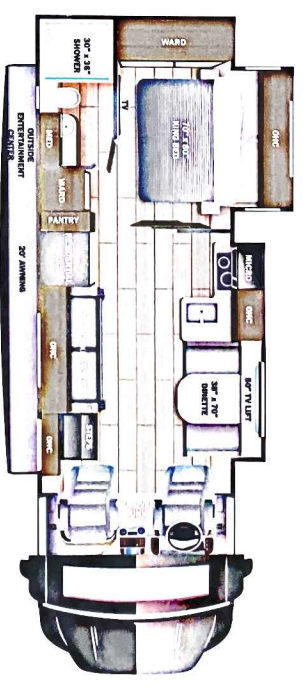

DIMENSIONS

Exterior height:.....144.00*
 Exterior width:.....101.00*
 Fresh water tank (gals.) :... 60.00
 Gray water tank (gals.) :... 38.00
 Black water/collet tank (gals.) :... 30.00
 Propane (lbs.) :... 83
 Water heater (gals.) :... 19
 Water heater (gals.) :... 8.00

CAPACITIES

Propane (lbs.) :... 83
 Water heater (gals.) :... 19
 Water heater (gals.) :... 8.00

TIRES

Tire size (front) :... 245/70R19.5G
 Tire size (mid) :...
 Tire size (rear) :... 245/70R19.5G

Some dimensions may be rounded and may vary from the actual dimensions
 ***Weights may be estimated calculations and may vary from the actual weight
 - refer to the vehicle weight labels for actual weights***
 Floorplans, features and specifications are subject to change without notice.